



Capacitor Discharge Resistor

Series PYP

Key Features

- High Power Dissipation upto 13W@25°C.
- Specially Designed to meet Repetitive Pulse Loading.
- Selected Premium Quality Resistance Wire.
- Corrosion Resistant Terminals for Long Life.
- Superior Vibration Resistance
- Reference Standards :
 - IEC 115-1



Electrical Specifications and Environmental Characteristics

Type	Power Rating		Ohmic Range	Limiting Voltage	Critical Value	Electrical Specifications	
	@25°C	@70°C				Climatic Category	55 / 200 / 56
	Watts	Watts		Volts	Ohms	Temperature Range	-55°C to 200°C
PYP 8	10	8.5	1R0 - 82K	685V	47K	Terminal Strength	>25N
						Derating	25°C to 350°C Linearly
PYP 10	13	11	1R0 - 120K	940V	68K	TCR	Standard ± 100 ppm/°C; On Request ± 30 ppm/°C
						Tolerance	$\pm 1\%$, $\pm 2\%$, $\pm 5\%$, $\pm 10\%$

Performance Characteristics

Test Methods	Test Conditions	Test Limits
Endurance at Rated Temperature	Full Rated Power for 1000hrs (1.5hrs ON, 0.5hrs OFF) at 25°C	$\Delta R < 5\% + 0R05$
Short Term Overload	10 x Rated Power for 5 secs, IEC 115-1, Clause 4.1.3	$\Delta R < 2\% + 0R05$
Damp Heat Steady State	90-95% RH, 40°C, 56 days, IEC 115-1, Clause 4.17.3	$\Delta R < 5\% + 0R05$
Climatic Sequence	As per IEC 115-1, Clause 4.23	$\Delta R < 5\% + 0R05$
Solderability	Not Applicable-Resistor is Designed for Screw Mounting Only	
Terminal Strength	25N Pull Test for 10 Seconds, IEC 115-1, Clause 4.16	$\Delta R < 0.5\% + 0R05$

Temperature Rise Graphs

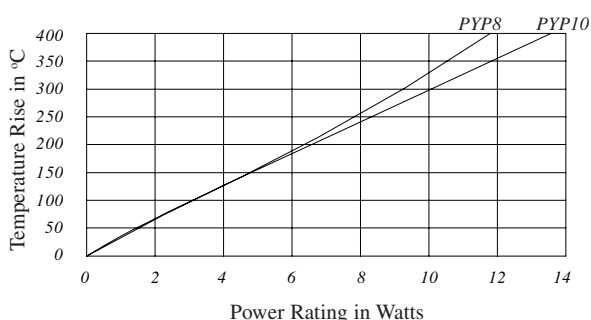

Derating Curve²

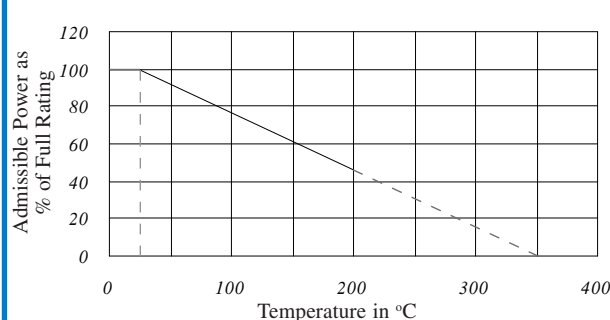

Dimensions

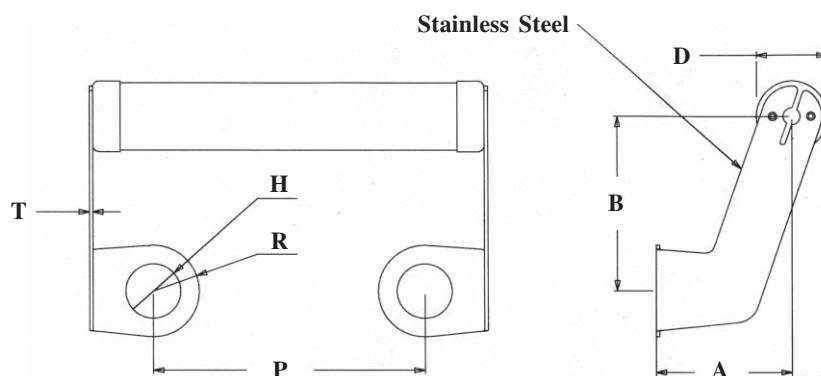

Do not Scale Drawings.
All dimensional tolerances in mm.

Dimensions (mm)

Type	P	A	B	D	T	R	H
	± 1	± 1	± 1	± 1	± 0.05	± 0.20	± 0.20
PYP8	22	15	21	9.5	0.40	5.35	6.35
PYP10	31.8	15	21	9.5	0.40	5.35	6.35

Dimensions (Inches)

Type	P	A	B	D	T	R	H
	± 0.039	± 0.039	± 0.039	± 0.039	± 0.0019	± 0.008	± 0.008
PYP8	0.866	0.590	0.827	0.374	0.0157	0.21	0.25
PYP10	1.252	0.590	0.827	0.374	0.0157	0.21	0.25

To Order - Please Specify

PEC Type.	Ohmic Value	Tolerance	Packing Style	Release Condition	Special Requirements
PYP10	0.1 Ohm » 0R1 / R10 1 Ohm » 1R0 1 KOhm » 1K0 10.7 KOhm » 10K7	1% » F 2% » G 5% » J 10% » K	Bulk » B	Commercial » X	Standard » S Others » M Please Specify

A Sample Part No.: **PYP10 1K0 JBXS**

Notes

- On request we undertake tests for Batch Acceptance to a specified Reference Standard.
- The Derating Curve specifies the maximum allowable Power at a particular ambient temperature while ensuring that the maximum surface temperature remains within the designed limit.
- When the Resistor is subjected to a Pulse Load, please ensure that the *average* Power dissipated remains below the rated Power specified.
- Resistor performance with Pulse Loads will have to be application tested. Please utilise our Pulse Application Questionnaire for selecting a suitable type or for requesting any design-in assistance from us.

Marketing Director
John A Stooke
Phone : +44 1793 737269
Mobile : +44 7836 609360
johnstooke@peccomponents.com

Global Sales Co-ordinator
K. K. Sajeev
Phone : +91 40 27126228 (Ext 213)
Mobile : +91 98666 55628
sales@peccomponents.com

European Sales
Gerhard Phalke
Phone : +49 8445 9299 755
Mobile : +49 151 55005510
pec@gerhard-phalke.de

To offer our products through regionally trusted services we have territory-wise and product-wise distribution, franchising, resale and private brand labelling arrangements. For cost-effective and enduring solutions to your needs, for tailored stocking/delivery scheduling, logistics and administrative support, please do not hesitate to contact us or any of our associated representatives, coordinators and product specialists.

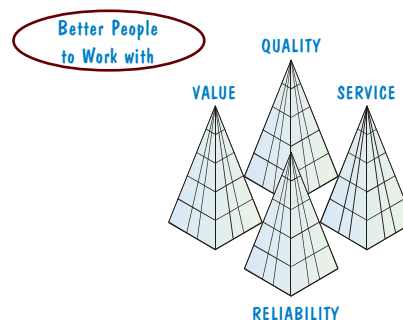

Thoughtful engineering and production by a well trained work-force, backed by strong design and development skills, enable us to maintain a level of manufacture and service recognised internationally.
At PEC we offer well-tuned customised support.